

VALVE SECTIONS USED FOR AIR MOTOR REPAIR KIT ONLY.

COMPLETE MANIFOLD ASSEMBLY
PART# YA50028

AIR MOTOR REPAIR KIT P/N: YA50025

| NO. | QTY | MANUFACTURER'S DESCRIPTION | PART # |
|-----|-----|----------------------------|---------|
| 31 | 2 | O-RING | YE60470 |
| 16 | 1 | NYLON BEARING 1/2" | YE40001 |
| 43 | 1 | U CUP | YE30025 |
| 47 | 4 | O-RING | YE60100 |
| 10 | 1 | PISTON SPACER | YE60100 |
| 48 | 2 | MUFFLER | YA60011 |
| 8 | 2 | PISTON BUMPER | YA50012 |
| 49 | 1 | SPRING | YA50027 |
| 50 | 1 | LT. VLV BUMPER | YA50017 |
| 51 | 1 | RT. VLV BUMPER | YA50018 |
| 33 | 1 | O-RING | YE60170 |
| 32 | 2 | O-RING | YE60040 |
| 53 | 2 | O-RING | YE60050 |
| 54 | 1 | VALVE SPOOL | YA50068 |
| 55 | 1 | AIR SPOOL | YA50021 |
| 56 | 1 | POP OFF VALVE | YA51161 |
| 57 | 2 | O-RING | YE60110 |
| 58 | 1 | VLV GASKET REVOL | YA50066 |

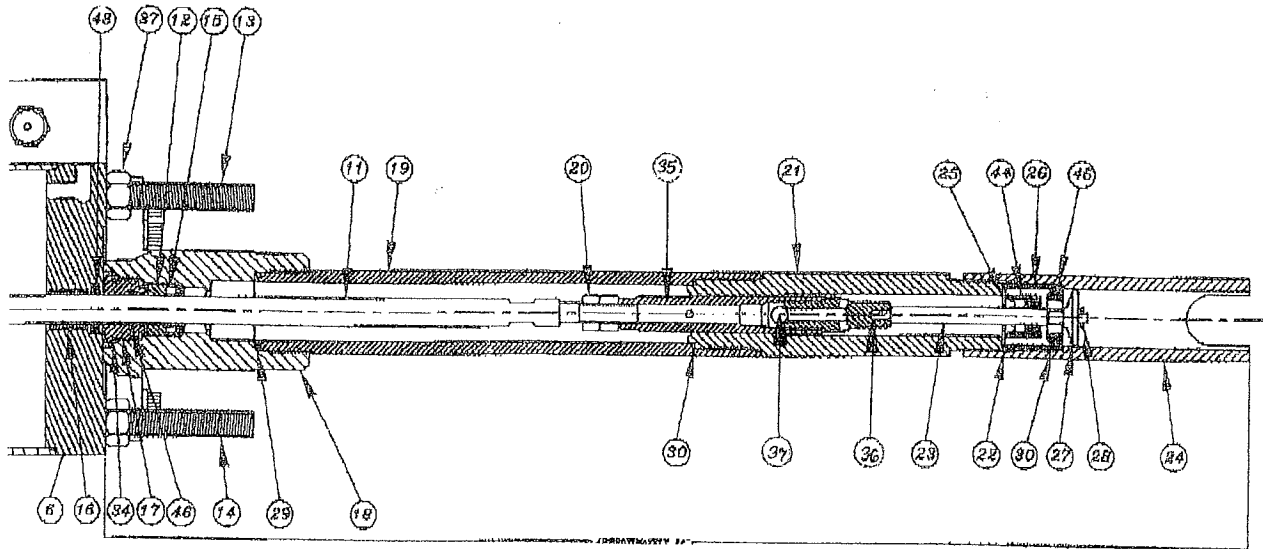

LOWER PUMP REPAIR KIT – PRT# AP23250

| NO. | QTY | MANUFACTURER'S DESCRIPTION | PART # |
|-----|-----|----------------------------|---------|
| 28 | 1 | COTTER PIN | YA50043 |
| 30 | 2 | MID-JOINT SEAL | YE60224 |
| 22 | 1 | O-RING | YE60230 |
| 26 | 1 | SPACER | AP33150 |
| 25 | 1 | 7-HOLE WASHER | YA50110 |
| 44 | 1 | FOOT VL.V. ASSY/COMPLETE | AP33135 |
| 15 | 1 | U-CUP | YA50032 |
| 12 | 1 | BRASS BACK UP | YA50031 |
| 34 | 1 | O-RING | YE60210 |
| 46 | 1 | O-RING | YE60600 |
| 29 | 1 | UPPER JOINT SEAL | YE60714 |

REPAIR KIT – PRT# AP33110

| NO. | QTY | MANUFACTURER'S DESCRIPTION | PART # |
|-----|-----|----------------------------|---------|
| 35 | 1 | PISTON BALL STOP | AP33050 |
| 36 | 1 | ADAPTOR | AP33080 |
| 37 | 1 | BALL | AP33070 |
| 21 | 1 | MID-SUCTION TUBE | AP33090 |